

HOLES PLOTTED

TOTAL 32

NT-036	NT-039	NT-045	NT-062
NT-063	NT-073	NT-075	NT-077
NT-079	NT-084	NT-085	NT-086
NT-087	NT-093	NT-095	NT-098
NT-151	NT-152	NT-153	NT-154
NT-155	NT-169	NT-176	NT-177
NT-178	NT-185	NT-186	NT-187
NT-188	NT-189	NT-192	NT-193

ROCK CODES	PAT	LABEL	DESCRIPTION
UHT	CAS	1a_Casing	1a_Casing
	OVB	Overburden	Overburden
	LC	1c_Loc	1c_Loc
	PT	2a_Tuff	2a_Tuff
	PLT	2b_Litic Tuff	2b_Litic Tuff
	PALT	2c_Altered Litic Tuff	2c_Altered Litic Tuff
	PU	2d_Un differentiated Pyroclastic	2d_Un differentiated Pyroclastic
	PCT	2e_Crystal Tuff	2e_Crystal Tuff
	UMT	11a_Ultramafic Tuff	11a_Ultramafic Tuff
	UMU	11c_Ultramafic Un differentiated	11c_Ultramafic Un differentiated
	UMBx	11d_Ultramafic Breccia	11d_Ultramafic Breccia
	UMF	11e_Ultramafic Flow	11e_Ultramafic Flow
	UA	11f_Ultramafic Altered	11f_Ultramafic Altered
	MT	3a_Mafic Tuff	3a_Mafic Tuff
	MD	3b_Mafic Dyke/Intrusive	3b_Mafic Dyke/Intrusive
	MU	3c_Mafic Un differentiated	3c_Mafic Un differentiated
	MF	3d_Mafic Flow	3d_Mafic Flow
	MV	3e_Megacrystic Mafic Volcanic	3e_Megacrystic Mafic Volcanic
	LS	4b_Interbedded Limestone and Seds	4b_Interbedded Limestone and Seds
	QPP	5a_Quartz Feldspar Porphyry	5a_Quartz Feldspar Porphyry
	FD	5b_Felsic Dyke	5b_Felsic Dyke
	FU	5c_Felsic Un differentiated	5c_Felsic Un differentiated
	FBx	5d_Felsic Breccia	5d_Felsic Breccia
	FT	5f_Felsic Tuff	5f_Felsic Tuff
	IT	6a_Intermediate Tuff	6a_Intermediate Tuff
	ID	6b_Intermediate Dyke	6b_Intermediate Dyke
	IU	6c_Intermediate Un differentiated	6c_Intermediate Un differentiated
	QP	Quartz Porphyry	Quartz Porphyry
	CTS	8a_Cherty Tuffaceous Seds	8a_Cherty Tuffaceous Seds
	CHT	8b_Chert	8b_Chert
	SMS	8c_Semi-massive Sulphide	8c_Semi-massive Sulphide
	MS	8d_Massive Sulphide	8d_Massive Sulphide
	ARG	8e_Angite-Mudstone	8e_Angite-Mudstone
	GRW	8f_Greywacke	8f_Greywacke
	SS	8g_Sandstone/Siltstone	8g_Sandstone/Siltstone
	CGL	8h_Conglomerate	8h_Conglomerate
	BOHT	9a_Banded Chert	9a_Banded Chert
	IF	9b_Iron Formation	9b_Iron Formation
	SbX	10a_Silica Bx	10a_Silica Bx
	SMSbX	10b_Silica-Sulphide Magnetite Bx	10b_Silica-Sulphide Magnetite Bx
	SFCbX	10f_Silica-Fe-Carbonate Breccia	10f_Silica-Fe-Carbonate Breccia
	IFB	10h_Iron Formation Breccia	10h_Iron Formation Breccia
	SSbX	10k_Silica Sulphide Bx	10k_Silica Sulphide Bx
	SCSbX	10l_Silica-Chlorite-Sulphide Bx	10l_Silica-Chlorite-Sulphide Bx

SECTION SPECS:

REF. PT. E, N 420817 m 5656377 m
EXTENTS 693.5 m 603.4 m
SECTION TOP, BOT 430.3 m -173.1 m
TOLERANCE +/- 20 m

SCALE 1 : 2500

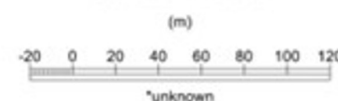

AZIMUTH = 195°

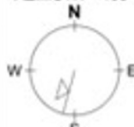

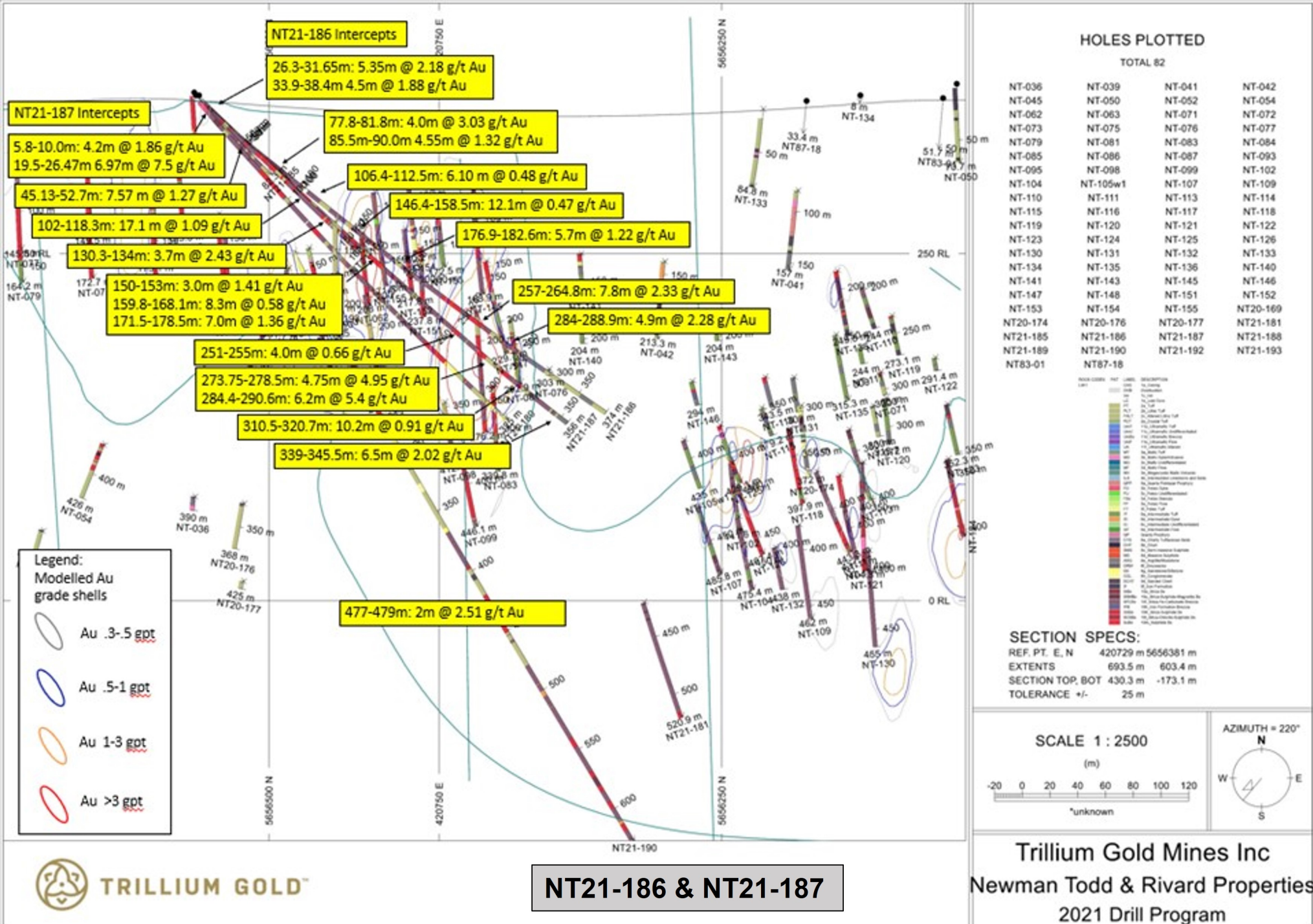

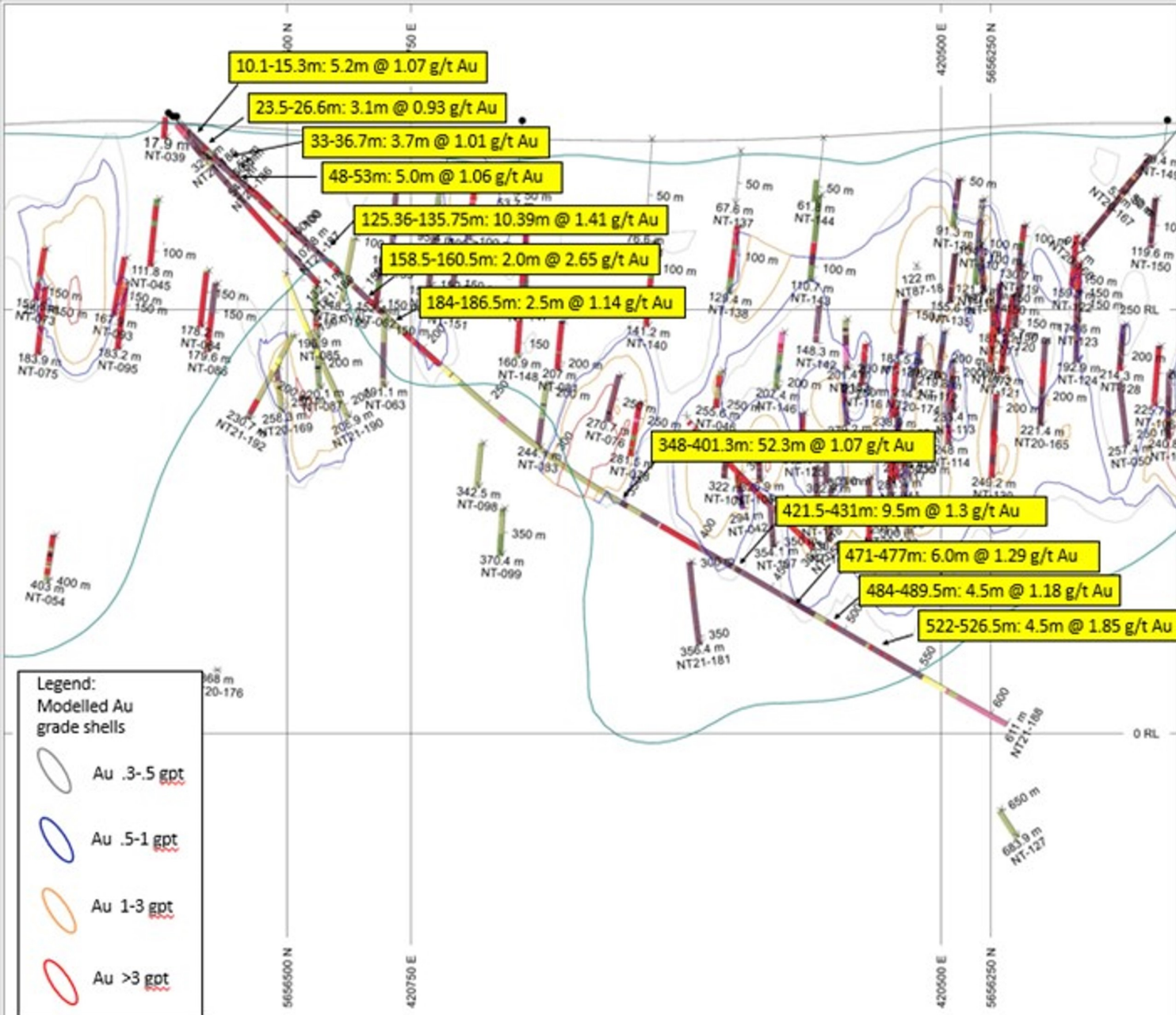

HOLES PLOTTED

TOTAL 95

NT-039	NT-041	NT-042	NT-045
NT-046	NT-050	NT-053	NT-054
NT-062	NT-063	NT-071	NT-072
NT-073	NT-075	NT-076	NT-078
NT-081	NT-083	NT-084	NT-085
NT-086	NT-087	NT-093	NT-095
NT-098	NT-099	NT-102	NT-104
NT-105	NT-105w1	NT-106	NT-107
NT-108	NT-109	NT-110	NT-111
NT-112	NT-113	NT-114	NT-115
NT-116	NT-117	NT-118	NT-119
NT-120	NT-121	NT-122	NT-123
NT-124	NT-125	NT-126	NT-127
NT-128	NT-130	NT-131	NT-132
NT-133	NT-134	NT-135	NT-136
NT-137	NT-138	NT-140	NT-141
NT-142	NT-143	NT-144	NT-145
NT-146	NT-147	NT-148	NT-149
NT-150	NT-151	NT-152	NT-153
NT-154	NT-155	NT-156	NT-157
NT-158	NT-159	NT-160	NT-161
NT-162	NT-163	NT-164	NT-165
NT-166	NT-167	NT-168	NT-169
NT-170	NT-171	NT-172	NT-173
NT-174	NT-175	NT-176	NT-177
NT-178	NT-179	NT-180	NT-181
NT-182	NT-183	NT-184	NT-185
NT-186	NT-187	NT-188	NT-189
NT-190	NT-191	NT-192	NT-193
NT-194	NT-195	NT-196	NT-197
NT-198	NT-199	NT-200	NT-201
NT-202	NT-203	NT-204	NT-205
NT-206	NT-207	NT-208	NT-209
NT-210	NT-211	NT-212	NT-213
NT-214	NT-215	NT-216	NT-217
NT-218	NT-219	NT-220	NT-221
NT-222	NT-223	NT-224	NT-225
NT-226	NT-227	NT-228	NT-229
NT-230	NT-231	NT-232	NT-233
NT-234	NT-235	NT-236	NT-237
NT-238	NT-239	NT-240	NT-241
NT-242	NT-243	NT-244	NT-245
NT-246	NT-247	NT-248	NT-249
NT-250	NT-251	NT-252	NT-253
NT-254	NT-255	NT-256	NT-257
NT-258	NT-259	NT-260	NT-261
NT-262	NT-263	NT-264	NT-265
NT-266	NT-267	NT-268	NT-269
NT-270	NT-271	NT-272	NT-273
NT-274	NT-275	NT-276	NT-277
NT-278	NT-279	NT-280	NT-281
NT-282	NT-283	NT-284	NT-285
NT-286	NT-287	NT-288	NT-289
NT-290	NT-291	NT-292	NT-293
NT-294	NT-295	NT-296	NT-297
NT-298	NT-299	NT-300	NT-301
NT-302	NT-303	NT-304	NT-305
NT-306	NT-307	NT-308	NT-309
NT-310	NT-311	NT-312	NT-313
NT-314	NT-315	NT-316	NT-317
NT-318	NT-319	NT-320	NT-321
NT-322	NT-323	NT-324	NT-325
NT-326	NT-327	NT-328	NT-329
NT-330	NT-331	NT-332	NT-333
NT-334	NT-335	NT-336	NT-337
NT-338	NT-339	NT-340	NT-341
NT-342	NT-343	NT-344	NT-345
NT-346	NT-347	NT-348	NT-349
NT-350	NT-351	NT-352	NT-353
NT-354	NT-355	NT-356	NT-357
NT-358	NT-359	NT-360	NT-361
NT-362	NT-363	NT-364	NT-365
NT-366	NT-367	NT-368	NT-369
NT-370	NT-371	NT-372	NT-373
NT-374	NT-375	NT-376	NT-377
NT-378	NT-379	NT-380	NT-381
NT-382	NT-383	NT-384	NT-385
NT-386	NT-387	NT-388	NT-389
NT-390	NT-391	NT-392	NT-393
NT-394	NT-395	NT-396	NT-397
NT-398	NT-399	NT-400	NT-401
NT-402	NT-403	NT-404	NT-405
NT-406	NT-407	NT-408	NT-409
NT-410	NT-411	NT-412	NT-413
NT-414	NT-415	NT-416	NT-417
NT-418	NT-419	NT-420	NT-421
NT-422	NT-423	NT-424	NT-425
NT-426	NT-427	NT-428	NT-429
NT-430	NT-431	NT-432	NT-433
NT-434	NT-435	NT-436	NT-437
NT-438	NT-439	NT-440	NT-441
NT-442	NT-443	NT-444	NT-445
NT-446	NT-447	NT-448	NT-449
NT-450	NT-451	NT-452	NT-453
NT-454	NT-455	NT-456	NT-457
NT-458	NT-459	NT-460	NT-461
NT-462	NT-463	NT-464	NT-465
NT-466	NT-467	NT-468	NT-469
NT-470	NT-471	NT-472	NT-473
NT-474	NT-475	NT-476	NT-477
NT-478	NT-479	NT-480	NT-481
NT-482	NT-483	NT-484	NT-485
NT-486	NT-487	NT-488	NT-489
NT-490	NT-491	NT-492	NT-493
NT-494	NT-495	NT-496	NT-497
NT-498	NT-499	NT-500	NT-501
NT-502	NT-503	NT-504	NT-505
NT-506	NT-507	NT-508	NT-509
NT-510	NT-511	NT-512	NT-513
NT-514	NT-515	NT-516	NT-517
NT-518	NT-519	NT-520	NT-521
NT-522	NT-523	NT-524	NT-525
NT-526	NT-527	NT-528	NT-529
NT-530	NT-531	NT-532	NT-533
NT-534	NT-535	NT-536	NT-537
NT-538	NT-539	NT-540	NT-541
NT-542	NT-543	NT-544	NT-545
NT-546	NT-547	NT-548	NT-549
NT-550	NT-551	NT-552	NT-553
NT-554	NT-555	NT-556	NT-557
NT-558	NT-559	NT-560	NT-561
NT-562	NT-563	NT-564	NT-565
NT-566	NT-567	NT-568	NT-569
NT-570	NT-571	NT-572	NT-573
NT-574	NT-575	NT-576	NT-577
NT-578	NT-579	NT-580	NT-581
NT-582	NT-583	NT-584	NT-585
NT-586	NT-587	NT-588	NT-589
NT-590	NT-591	NT-592	NT-593
NT-594	NT-595	NT-596	NT-597
NT-598	NT-599	NT-600	NT-601
NT-602	NT-603	NT-604	NT-605
NT-606	NT-607	NT-608	NT-609
NT-610	NT-611	NT-612	NT-613
NT-614	NT-615	NT-616	NT-617
NT-618	NT-619	NT-620	NT-621
NT-622	NT-623	NT-624	NT-625
NT-626	NT-627	NT-628	NT-629
NT-630	NT-631	NT-632	NT-633
NT-634	NT-635	NT-636	NT-637
NT-638	NT-639	NT-640	NT-641
NT-642	NT-643	NT-644	NT-645
NT-646	NT-647	NT-648	NT-649
NT-650	NT-651	NT-652	NT-653
NT-654	NT-655	NT-656	NT-657
NT-658	NT-659	NT-660	NT-661
NT-662	NT-663	NT-664	NT-665
NT-666	NT-667	NT-668	NT-669
NT-670	NT-671	NT-672	NT-673
NT-674	NT-675	NT-676	NT-677
NT-678	NT-679	NT-680	NT-681
NT-682	NT-683	NT-684	NT-685
NT-686	NT-687	NT-688	NT-689
NT-690	NT-691	NT-692	NT-693
NT-694	NT-695	NT-696	NT-697
NT-698	NT-699	NT-700	NT-701
NT-702	NT-703	NT-704	NT-705
NT-706	NT-707	NT-708	NT-709
NT-710	NT-711	NT-712	NT-713
NT-714	NT-715	NT-716	NT-717
NT-718	NT-719	NT-720	NT-721
NT-722	NT-723	NT-724	NT-725
NT-726	NT-727	NT-728	NT-729
NT-730	NT-731	NT-732	NT-733
NT-734	NT-735	NT-736	NT-737
NT-738	NT-739	NT-740	NT-741
NT-742	NT-743	NT-744	NT-745
NT-746	NT-747	NT-748	NT-749
NT-750	NT-751	NT-752	NT-753
NT-754	NT-755	NT-756	NT-757
NT-758	NT-759	NT-760	NT-761
NT-762	NT-763	NT-764	NT-765
NT-766	NT-767	NT-768	NT-769
NT-770	NT-771	NT-772	NT-773
NT-774	NT-775	NT-776	NT-777
NT-778	NT-779	NT-780	NT-781
NT-782	NT-783	NT-784	NT-785
NT-786	NT-787	NT-788	NT-789
NT-790	NT-791	NT-792	NT-793
NT-794	NT-795	NT-796	NT-797
NT-798	NT-799	NT-800	NT-801
NT-802	NT-803	NT-804	NT-805
NT-806	NT-807	NT-808	NT-809
NT-810	NT-811	NT-812	NT-813
NT-814	NT-815	NT-816	NT-817
NT-818	NT-819	NT-820	NT-821
NT-822	NT-823	NT-824	NT-825
NT-826	NT-827	NT-828	NT-829
NT-830	NT-831	NT-832	NT-833
NT-834	NT-835	NT-836	NT-837
NT-838	NT-839	NT-840	NT-841
NT-842	NT-843	NT-844	NT-845
NT-846	NT-847	NT-848	NT-849
NT-850	NT-851	NT-852	NT-853
NT-854	NT-855	NT-856	NT-857
NT-858	NT-859	NT-860	NT-861
NT-862	NT-863	NT-864	NT-865
NT-866	NT-867	NT-868	NT-869
NT-870	NT-871	NT-872	NT-873
NT-874	NT-875	NT-876	NT-877
NT-878	NT-879	NT-880	NT-881
NT-882	NT-883	NT-884	NT-885
NT-886	NT-887	NT-888	NT-889
NT-890	NT-891	NT-892	NT-893
NT-894	NT-895	NT-896	NT-897
NT-898	NT-899	NT-900	NT-901
NT-902	NT-903	NT-904	NT-905
NT-906	NT-907	NT-908	NT-909
NT-910	NT-911	NT-912	NT-913
NT-914	NT-915	NT-916	NT-917
NT-918	NT-919	NT-920	NT-921
NT-922	NT-923	NT-924	NT-925
NT-926	NT-927	NT-928	NT-929
NT-930	NT-931	NT-932	NT-933
NT-934	NT-935	NT-936	NT-937
NT-938	NT-939	NT-940	NT-941
NT-942	NT-943	NT-944	NT-945
NT-946	NT-947	NT-948	NT-949
NT-950	NT-951	NT-952	NT-953
NT-954	NT-955	NT-956	NT-957
NT-958	NT-959	NT-960	NT-961
NT-962	NT-963	NT-964	NT-965
NT-966	NT-967	NT-968	NT-969
NT-970	NT-971	NT-972	NT-973
NT-974	NT-975	NT-976	NT-977
NT-978	NT-979	NT-980	NT-981
NT-982	NT-983	NT-984	NT-985
NT-986	NT-987	NT-988	NT-989
NT-990	NT-991	NT-992	NT-993
NT-994	NT-995	NT-996	NT-997
NT-998	NT-999	NT-1000	NT-1001

SECTION SPECS:

REF. PT. E, N 420865 m 5656392 m
EXTENTS 693.5 m 603.4 m
SECTION TOP, BOT 430.3 m -173.1 m
TOLERANCE +/- 15 m

SCALE 1 : 2500

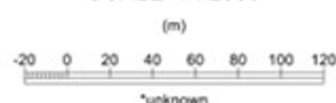

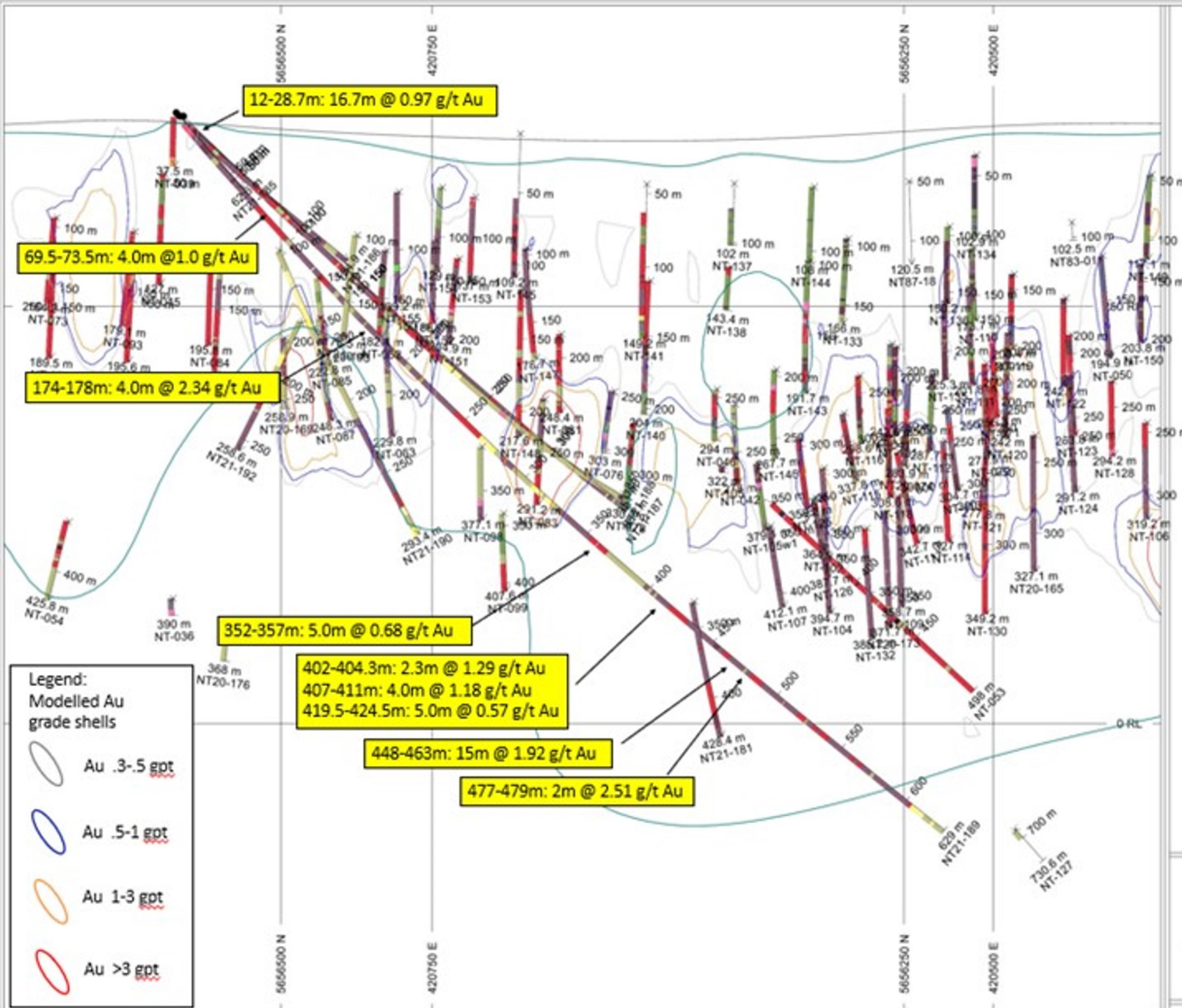

HOLES PLOTTED

TOTAL 93

NT-036	NT-039	NT-041	NT-042
NT-045	NT-046	NT-050	NT-053
NT-054	NT-062	NT-063	NT-071
NT-072	NT-073	NT-075	NT-076
NT-078	NT-081	NT-083	NT-084
NT-085	NT-086	NT-087	NT-093
NT-095	NT-098	NT-099	NT-102
NT-104	NT-105	NT-105w1	NT-106
NT-107	NT-109	NT-110	NT-111
NT-112	NT-113	NT-114	NT-115
NT-116	NT-117	NT-118	NT-119
NT-120	NT-121	NT-122	NT-123
NT-124	NT-125	NT-126	NT-127
NT-128	NT-130	NT-131	NT-132
NT-133	NT-134	NT-135	NT-136
NT-137	NT-138	NT-140	NT-141
NT-143	NT-144	NT-145	NT-146
NT-147	NT-148	NT-149	NT-150
NT-151	NT-152	NT-153	NT-154
NT-155	NT-165	NT-169	NT-173
NT-174	NT-176	NT-181	NT-185
NT-186	NT-187	NT-188	NT-189
NT-190	NT-192	NT-193	NT-199
NT-198			NT-201



SECTION SPECS:

REF. PT. E, N 420683 m 5656379 m
EXTENTS 693.5 m 603.4 m
SECTION TOP, BOT 430.3 m -173.1 m
TOLERANCE +/- 25 m

SCALE 1 : 2500

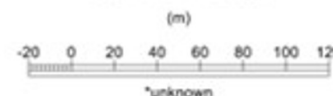

AZIMUTH = 228°

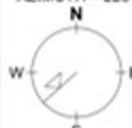

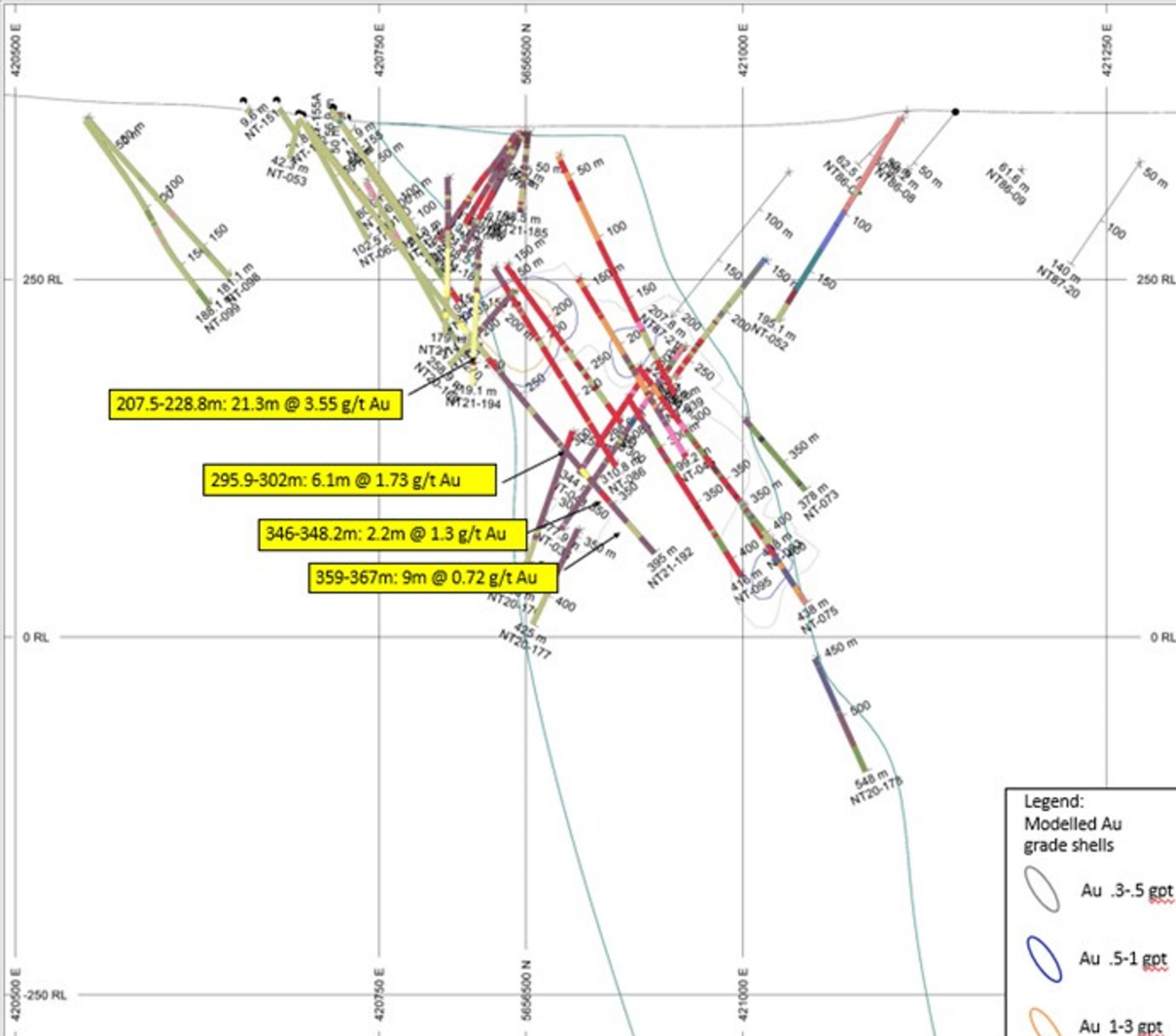

HOLES PLOTTED

TOTAL 41

NT-036	NT-039	NT-043	NT-045
NT-052	NT-053	NT-054	NT-062
NT-063	NT-073	NT-075	NT-084
NT-085	NT-086	NT-087	NT-093
NT-095	NT-098	NT-099	NT-151
NT-152	NT-155	NT-155A	NT20-169
NT20-176	NT20-177	NT20-178	NT21-185
NT21-186	NT21-187	NT21-188	NT21-189
NT21-190	NT21-192	NT21-193	NT21-194
NT86-07	NT86-08	NT86-09	NT87-20

ROCK CODES	PAT	LABEL	DESCRIPTION
LMH		CAS	1a_Casing
		OVB	Overburden
		SL	1a_Site
		LC	1a_Low Core
		PT	2a_Tuff
		PLT	2a_Lithic Tuff
		PALT	2a_Altered Lithic Tuff
		PU	2a_Undifferentiated Pyroclastic
		PCT	2a_Crystal Tuff
		UMT	11a_Ultramafic Tuff
		UMU	11a_Ultramafic Undifferentiated
		UMUx	11a_Ultramafic Breccia
		UMF	11a_Ultramafic Flow
		UA	11a_Ultramafic Altered
		MT	3a_Mafic Tuff
		MO	3a_Mafic Dyke/Intrusive
		MU	3a_Mafic Undifferentiated
		MF	3a_Mafic Flow
		MV	3a_Magmatic Mafic Volcanic
		LS	4a_Interbedded Limestone and Silt
		QFP	5a_Quartz Felsic Porphyry
		FD	5a_Felsic Dyke
		PU	5a_Felsic Undifferentiated
		FT	5a_Felsic Tuff
		IT	6a_Intermediate Tuff
		ID	6a_Intermediate Dyke
		IM	6a_Intermediate Undifferentiated
		QP	Quartz Porphyry
		CTS	8a_Cherty Tuffaceous Silt
		CHT	8a_Chert
		SMS	8a_Semi-massive Sulphide
		MS	8a_Massive Sulphide
		ARG	8a_Angite/Muscovite
		GRW	8a_Greywacke
		SS	8a_Sandstone/Siltstone
		COL	8a_Conglomerate
		BOHT	8a_Banded Chert
		IF	8a_Iron Formation
		SILx	10a_Silica Bx
		SILMx	10a_Silica-Sulphide Magnetite Bx
		SFCBx	10a_Silica-Fe-Carbonate Breccia
		IFB	10a_Iron Formation Breccia
		SILSx	10a_Silica-Sulphide Bx
		SCMx	10a_Silica-Chert-Sulphide Bx
		SULx	10a_Sulphide Bx

SECTION SPECS:

REF. PT. E, N 420902 m 5656491 m
 EXTENTS 832.2 m 724.1 m
 SECTION TOP, BOT 442.4 m -281.7 m
 TOLERANCE +/- 30 m

Legend:
 Modelled Au
 grade shells



SCALE 1 : 3000

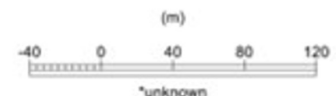

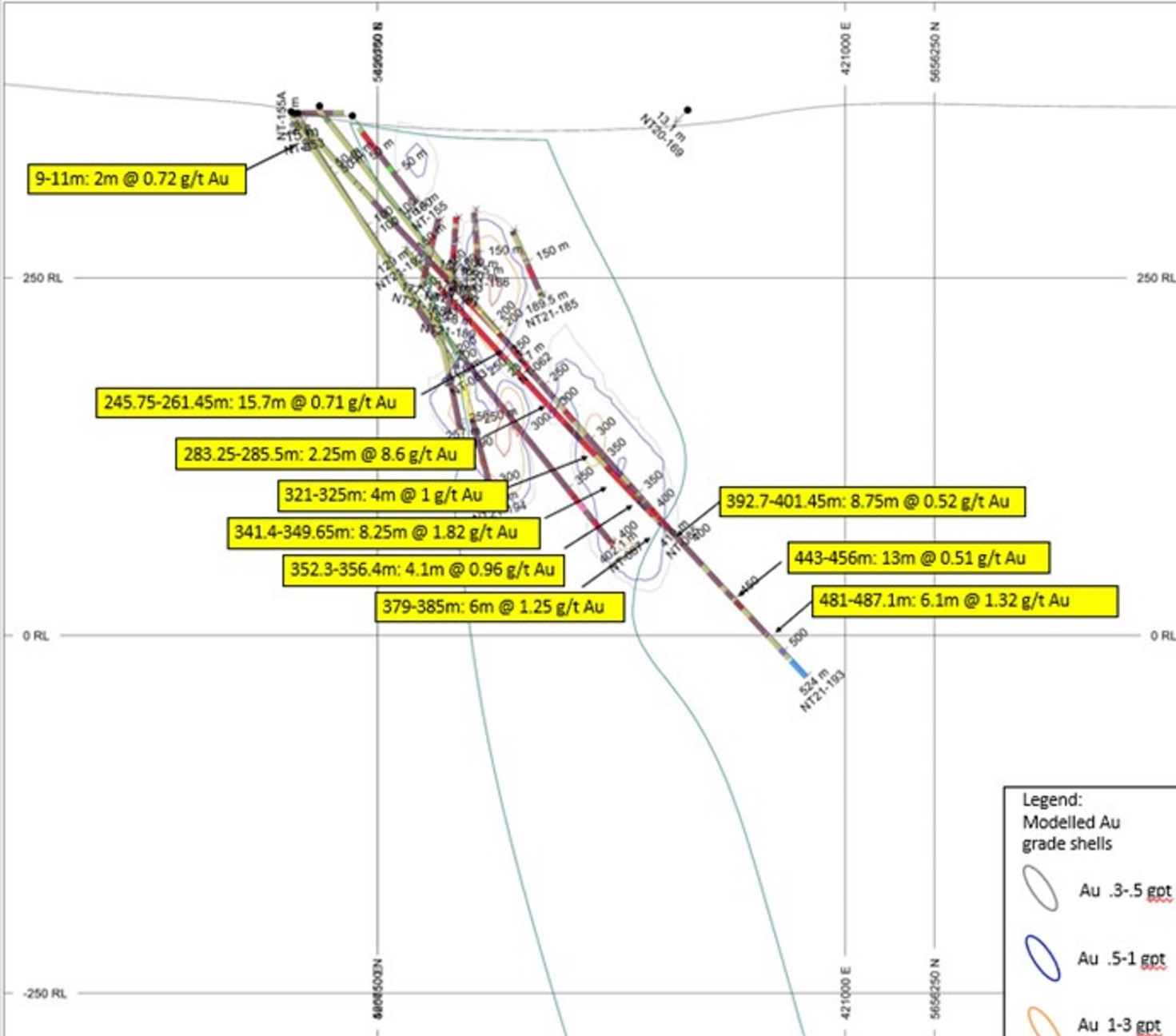

HOLES PLOTTED

TOTAL 17

NT-053	NT-062	NT-063	NT-085
NT-087	NT-155	NT-155A	NT20-169
NT21-185	NT21-186	NT21-187	NT21-188
NT21-189	NT21-190	NT21-192	NT21-193
NT21-194			

ROCK CODES	PAT	LABEL	DESCRIPTION
Lith1		CAS	1a_Casing
		OVB	Overburden
		LC	1e_Lost Core
		PT	2a_Tuff
		PLT	2b_Lithic Tuff
		PALT	2c_Altered Lithic Tuff
		PCT	2e_Crystal Tuff
		UmU	11c_Ultramafic Undifferentiated
		UA	11f_Ultramafic Altered
		MT	3a_Mafic Tuff
		MD	3b_Mafic Dyke/Intrusive
		MV	3e_Megacrystic Mafic Volcanic
		QFP	5a_Quartz Feldspar Porphyry
		FD	5b_Felsic Dyke
		FU	5c_Felsic Undifferentiated
		FT	5f_Felsic Tuff
		IT	6a_Intermediate Tuff
		ID	6b_Intermediate Dyke
		QP	Quartz Porphyry
		CTS	8a_Cherty Tuffaceous Seds
		CHT	8b_Chert
		SMS	8c_Semi-massive Sulphide
		ARG	8e_Argillite/Mudstone
		SS	8g_Sandstone/Siltstone
		CGL	8h_Conglomerate
		BCHT	9d_Banded Chert
		IF	9f_Iron Formation
		SiBx	10a_Silica Bx
		SSMBx	10e_Silica-Sulphide-Magnetite Bx
		SFCBx	10f_Silica-Fe-Carbonate Breccia
		IFB	10h_Iron Formation Breccia
		SSBx	10K_Silica-Sulphide Bx
		SCSBx	10L_Silica-Chlorite-Sulphide Bx

SECTION SPECS:

REF. PT. E, N	420869 m	5656400 m
EXTENTS	832.2 m	724.1 m
SECTION TOP, BOT	442.4 m	-281.7 m
TOLERANCE +/-	25 m	

SCALE 1 : 3000

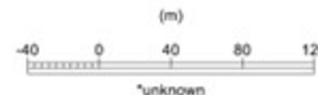

AZIMUTH = 130°

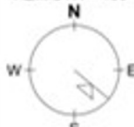

Legend:
Modelled Au
grade shells

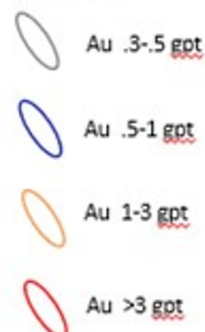

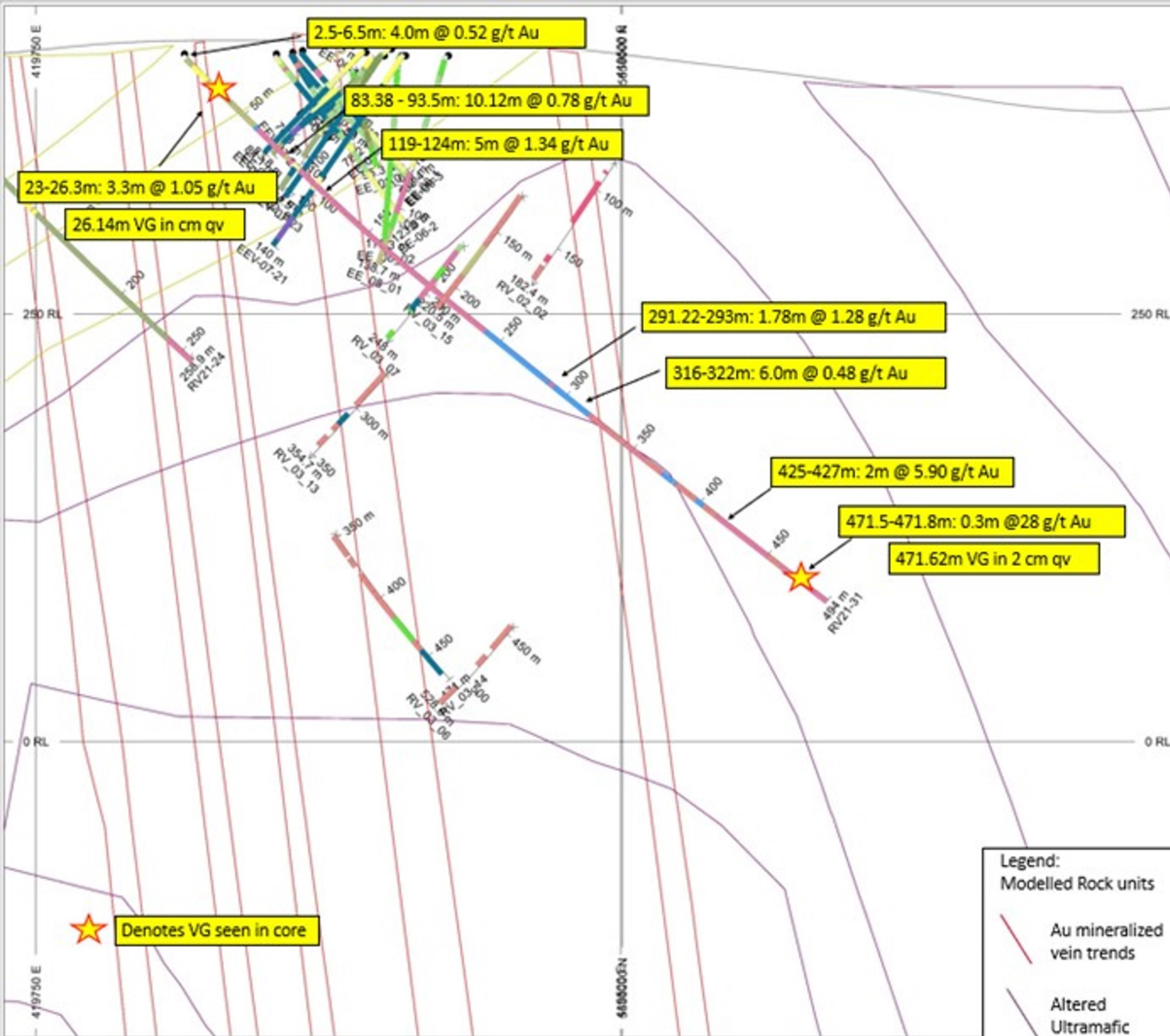

HOLES PLOTTED

TOTAL 23

EE-06-1	EE-06-11	EE-06-2	EE-06-3
EE-06-4	EE-06-5	EE-06-6	EE-06-7
EE-08-01	EE-08-02	EE-08-03	EEV-07-21
EEV-07-22	EEV-07-23	RV21-24	RV21-31
RV-02-01	RV-02-02	RV-03-06	RV-03-07
RV-03-13	RV-03-14	RV-03-15	

ROCK CODES	PAT	LABEL	DESCRIPTION
Lith1	CAS	1a_Casing	
	OVb	Overburden	
	PT	2a_Tuff	
	PLT	2b_Lithic Tuff	
	PALT	2c_Altered Lithic Tuff	
	PU	2d_Undifferentiated Pyroclastic	
	PCT	2e_Crystal Tuff	
	UmBx	11d_Ultramafic Breccia	
	UA	11f_Ultramafic Altered	
	MD	3b_Mafic Dyke/Intrusive	
	MU	3c_Mafic Undifferentiated	
	QFP	5a_Quartz Feldspar Porphyry	
	FD	5b_Felsic Dyke	
	FU	5c_Felsic Undifferentiated	
	FBx	5d_Felsic Breccia	
	FT	5f_Felsic Tuff	
	IT	6a_Intermediate Tuff	
	ID	6b_Intermediate Dyke	
	IU	6c_Intermediate Undifferentiated	
	IB	6d_Intermediate Breccia	
	LD	Lamprophyre Dyke	
	QP	Quartz Porphyry	
	QCV	7e_Quartz Carbonate Vein	
	CHT	8b_Chert	
	SS	8g_Sandstone/Siltstone	
	CGL	8h_Conglomerate	

SECTION SPECS:

REF. PT. E, N 419510 m 5656010 m
 EXTENTS 693.5 m 603.4 m
 SECTION TOP, BOT 430.3 m -173.1 m
 TOLERANCE +/- 30 m

Legend:

Modelled Rock units

Au mineralized vein trends

Altered Ultramafic

Sandstone, Conglomerate

SCALE 1 : 2500

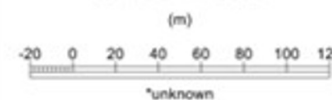

AZIMUTH = 227°

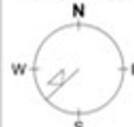

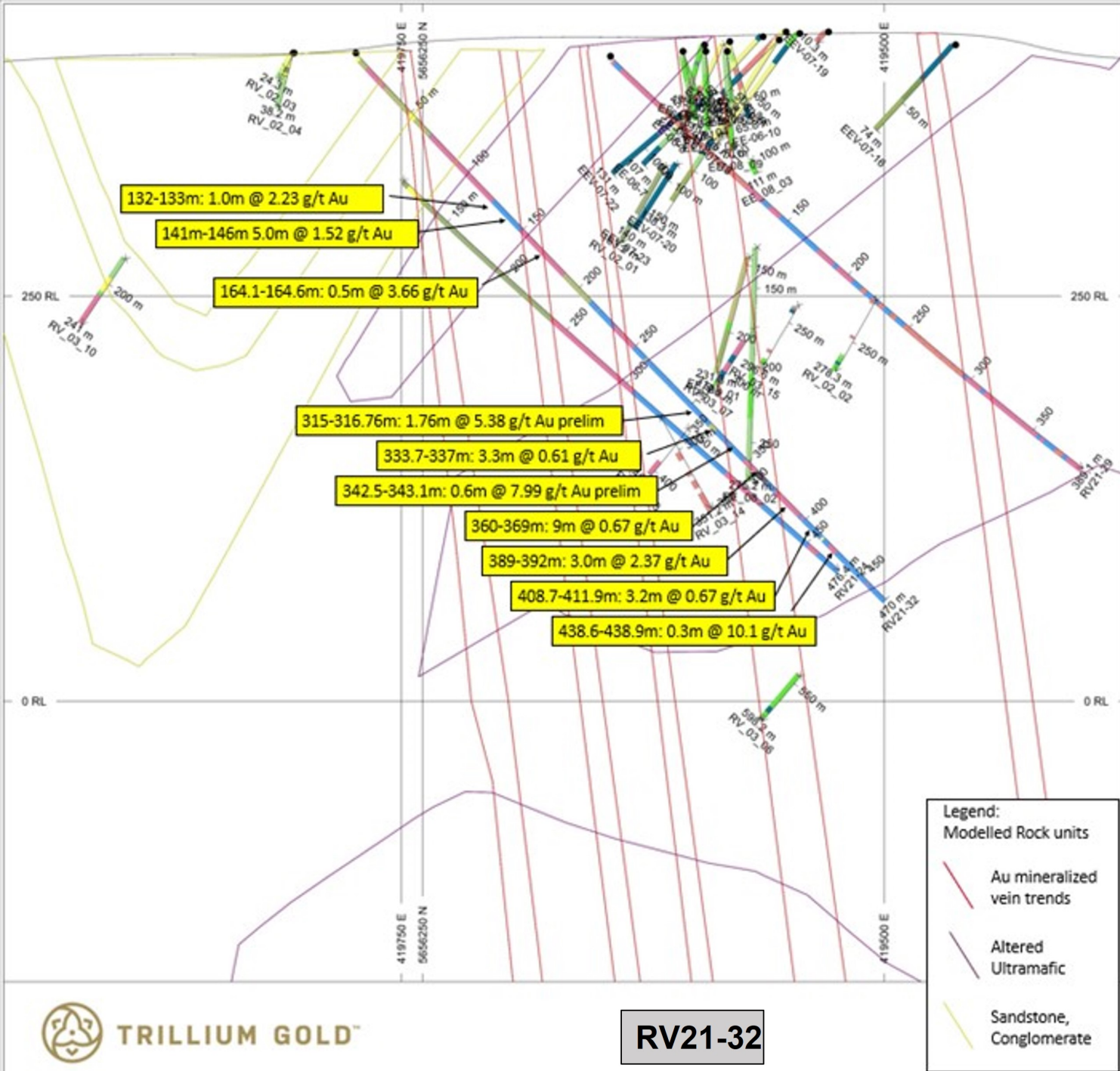

HOLES PLOTTED

TOTAL 34

EE-06-10	EE-06-11	EE-06-7	EE-06-8
EE-06-9	EE-08_01	EE-08_02	EE-08_03
EE-08_04	EE-08_05	EE-08_06	EE-08_07
EE-08_08	EE-08_09	EE-08_12	EEV-07-16
EEV-07-18	EEV-07-19	EEV-07-20	EEV-07-22
EEV-07-23	RV21-24	RV21-29	RV21-32
RV_02_01	RV_02_02	RV_02_03	RV_02_04
RV_03_06	RV_03_07	RV_03_10	RV_03_13
RV_03_14	RV_03_15		

ROCK CODES	PAT	LABEL	DESCRIPTION
Lith1		CAS	1a_Casing
		OVB	Overburden
		PT	2a_Tuff
		PLT	2b_Lithic Tuff
		PU	2c_Undifferentiated Pyroclastic
		PCT	2e_Crystal Tuff
		UmBx	11d_Ultramafic Breccia
		UA	11f_Ultramafic Altered
		MD	3b_Mafic Dyke/Intrusive
		MU	3c_Mafic Undifferentiated
		MV	3e_Megacrystic Mafic Volcanic
		QFP	5a_Quartz Feldspar Porphyry
		FD	5b_Felsic Dyke
		FU	5c_Felsic Undifferentiated
		FBx	5d_Felsic Breccia
		FT	5f_Felsic Tuff
		IT	6a_Intermediate Tuff
		ID	6b_Intermediate Dyke
		IU	6c_Intermediate Undifferentiated
		IB	6d_Intermediate Breccia
		LD	Lamprophyre Dyke
		QP	Quartz Porphyry
		QCV	7e_Quartz Carbonate Vein
		CHT	8b_Chert
		GRW	8f_Greywacke
		SS	8g_Sandstone/Siltstone
		CGL	8h_Conglomerate

SECTION SPECS:

REF. PT. E, N	419665 m 5656202 m
EXTENTS	693.5 m 603.4 m
SECTION TOP, BOT	430.3 m -173.1 m
TOLERANCE +/-	22.5 m

SCALE 1 : 2500

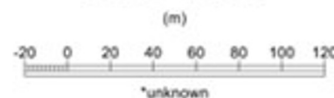

AZIMUTH = 237°

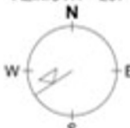

Trillium Gold Mines Inc
Newman Todd & Rivard Properties
2021 Drill Program

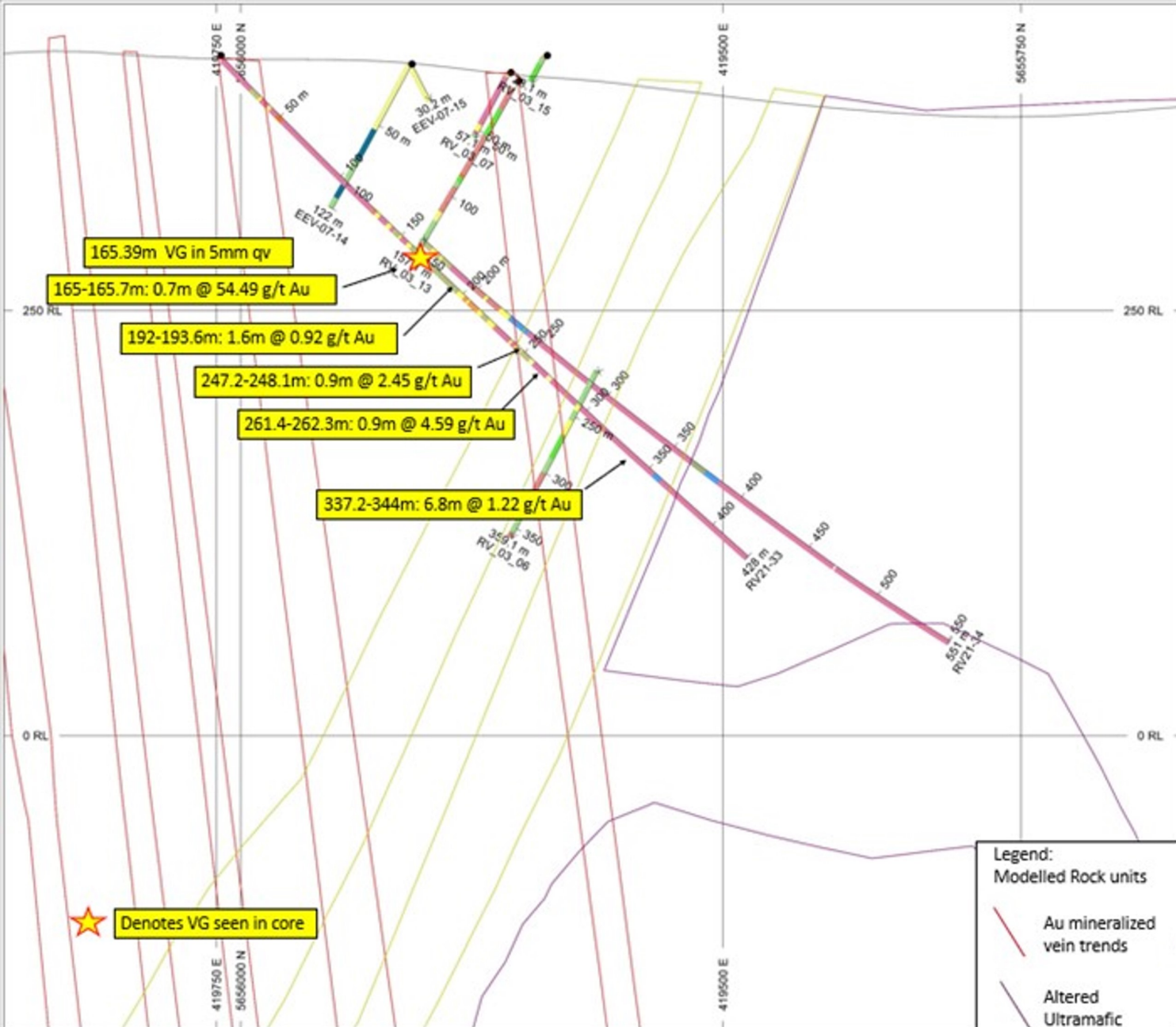

HOLES PLOTTED

TOTAL 8

EEV-07-14 RV_03_06	EEV-07-15 RV_03_07	RV21-33 RV_03_13	RV21-34 RV_03_15

ROCK CODES	PAT	LABEL	DESCRIPTION
Lith1		CAS	1a_Casing
		OVB	Overburden
		LC	1e_Lost Core
		PT	2a_Tuff
		PLT	2b_Lithic Tuff
		PCT	2e_Crystal Tuff
		UA	11f_Ultramafic Altered
		MD	3b_Mafic Dyke/Intrusive
		MU	3c_Mafic Undifferentiated
		QFP	5a_Quartz Feldspar Porphyry
		FU	5c_Felsic Undifferentiated
		FT	5f_Felsic Tuff
		ID	6b_Intermediate Dyke
		IU	6c_Intermediate Undifferentiated
		QP	Quartz Porphyry
		QCV	7e_Quartz Carbonate Vein
		CTS	8a_Cherty Tuffaceous Seds
		CHT	8b_Chert
		SS	8g_Sandstone/Siltstone
		CGL	8h_Conglomerate

SECTION SPECS:

REF. PT. E, N 419564 m 5655887 m
 EXTENTS 693.5 m 603.4 m
 SECTION TOP, BOT 430.3 m -173.1 m
 TOLERANCE +/- 50 m

Legend:

Modelled Rock units

- Au mineralized vein trends
- Altered Ultramafic
- Sandstone, Conglomerate

SCALE 1 : 2500

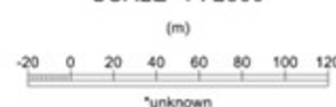

AZIMUTH = 237°

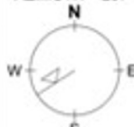

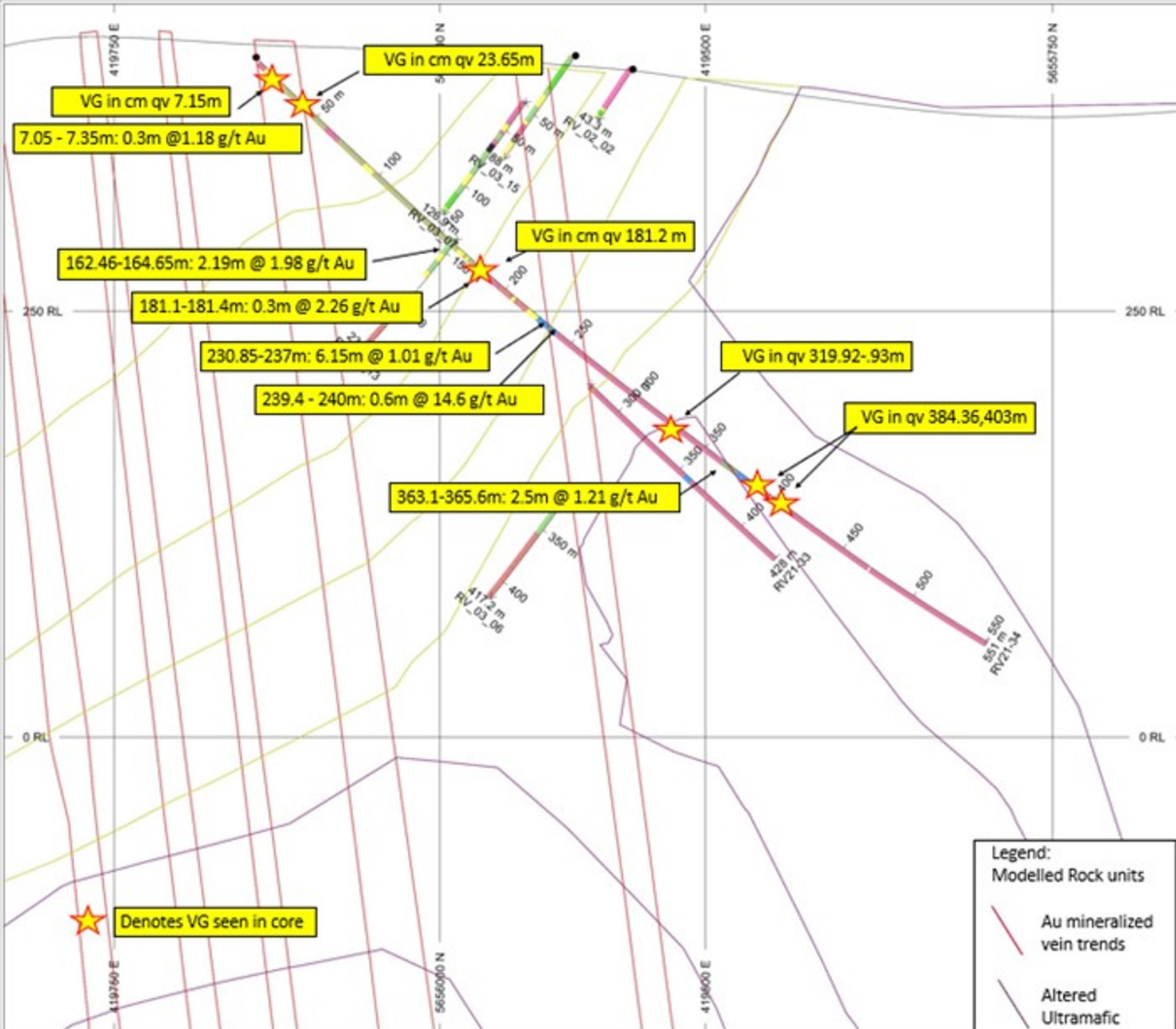

HOLES PLOTTED

TOTAL 7

RV21-33	RV21-34	RV_02_02	RV_03_06
RV_03_07	RV_03_13	RV_03_15	

ROCK CODES	PAT	LABEL	DESCRIPTION
Lith1		CAS	1a_Casing
		OVB	Overburden
		LC	1e_Lost Core
		PT	2a_Tuff
		PLT	2b_Lithic Tuff
		PCT	2e_Crystal Tuff
		UA	11f_Ultramafic Altered
		MD	3b_Mafic Dyke/Intrusive
		MU	3c_Mafic Undifferentiated
		QFP	5a_Quartz Feldspar Porphyry
		FD	5b_Felsic Dyke
		FU	5c_Felsic Undifferentiated
		FT	5f_Felsic Tuff
		ID	6b_Intermediate Dyke
		IU	6c_Intermediate Undifferentiated
		QP	Quartz Porphyry
		QCV	7e_Quartz Carbonate Vein
		CTS	8a_Cherty Tuffaceous Seds
		CHT	8b_Chert
		SS	8g_Sandstone/Siltstone
		CGL	8h_Conglomerate

SECTION SPECS:

REF. PT. E, N 419547 m 5655937 m
EXTENTS 693.5 m 603.4 m
SECTION TOP, BOT 430.3 m -173.1 m
TOLERANCE +/- 30 m

Legend:

- Modelled Rock units
- Au mineralized vein trends
- Altered Ultramafic
- Sandstone, Conglomerate

SCALE 1 : 2500

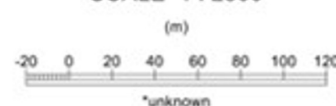

AZIMUTH = 226°

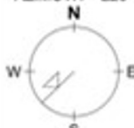

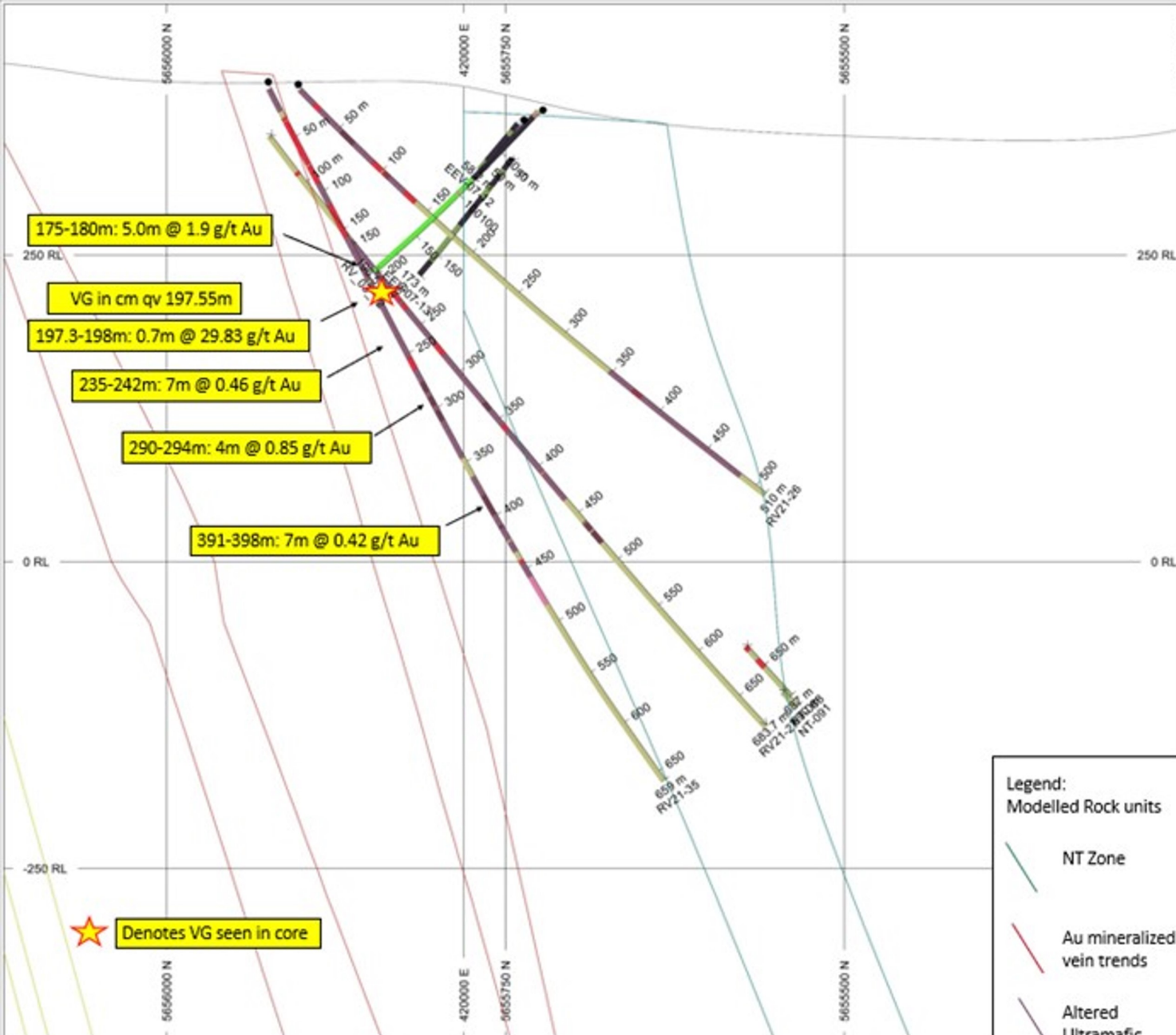

HOLES PLOTTED

TOTAL 8

EEV-07-12 RV21-26	EEV-07-13 RV21-27	NT-088 RV21-35	NT-091 RV_03_12

ROCK CODES	PAT	LABEL	DESCRIPTION
Lith1			
CAS		1a_Casing	
OVb		Overburden	
PT		2a_Tuff	
PLT		2b_Lithic Tuff	
PCT		2e_Crystal Tuff	
MD		3b_Mafic Dyke/Intrusive	
QFP		5a_Quartz Feldspar Porphyry	
FU		5c_Felsic Undifferentiated	
IT		6a_Intermediate Tuff	
ID		6b_Intermediate Dyke	
IU		6c_Intermediate Undifferentiated	
QP		Quartz Porphyry	
QCV		7e_Quartz Carbonate Vein	
CTS		8a_Cherty Tuffaceous Seds	
CHT		8b_Chert	
ARG		8e_Argillite/Mudstone	
IF		9f_Iron Formation	
SiBx		10a_Silica Bx	
SSMBx		10e_Silica-Sulphide-Magnetite Bx	
SFCBx		10f_Silica-Fe-Carbonate Breccia	
IFB		10h_Iron Formation Breccia	
SSBx		10K_Silica-Sulphide Bx	
SuBx		10m_Sulphide Bx	

SECTION SPECS:

REF. PT. E, N 420047 m 5655680 m
 EXTENTS 970.9 m 844.8 m
 SECTION TOP, BOT 454.5 m -390.3 m
 TOLERANCE +/- 40 m

Legend: Modelled Rock units

- NT Zone
- Au mineralized vein trends
- Altered Ultramafic
- Sandstone, Conglomerate

SCALE 1 : 3500

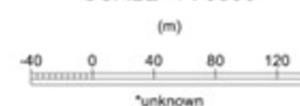

AZIMUTH = 155°

